



LIFTING TOOLS
**HYDRAULIC
 CYLINDERS**



Ultra-Flat Cylinders

Working pressure: 700 bar

Single-acting, gravity-return.
 Extremely low collapsed height.
 Each cylinder comes with a 3/8 NPT female coupler (optional HC7003F / HC7004F).



Model	Cylinder Capacity @700 bar		Stroke (mm)	Effective area (cm ²)
	Ton	KN		
HHYG-3515CCB	35	351.6	15	50.2
HHYG-7015CCB	70	726.7	15	103.8
HHYG-10015CCB	100	1077	15	153.5

Ultra-High Pressure Ultra-Flat Cylinders

Working pressure: 1500 bar

Single-acting, gravity-return.
 Extremely low collapsed height.
 Each cylinder comes with an ultra-high pressure male coupler HC15001M.



Model	Cylinder Capacity @700 bar		Stroke (mm)	Effective area (cm ²)	Oil capacity (cm ³)
	Ton	KN			
HHYG-510CGB	5	51.9	10	3.46	3.5
HHYG-1010CGB	10	105.9	10	7.06	7.1
HHYG-2510CGB	25	260.1	10	17.34	17.3
HHYG-5010CGB	50	576.9	10	38.46	38.5
HHYG-10010CGB	100	1040.4	10	69.36	69.4
HHYG-15010CGB	150	1584.4	10	105.62	105.6
HHYG-20010CGB	200	2051.6	10	136.77	136.8



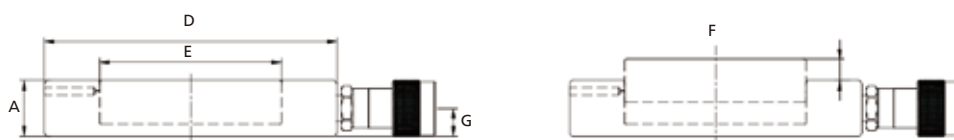

Oil capacity (cm ³)	Closed height A (mm)	Extended Height B (mm)	Outside Dia. DXL (mm)	Inside Dia. E (mm)	Piston Rod Dia. F (mm)	Bottom to Advance Port G (mm)	G.W. (Kg)	Model
75	35	50	150	80	80	17.5	5	HHYG-3515CCB
156	35	50	185	115	115	17.5	7.5	HHYG-7015CCB
231	41	56	210	140	140	19	11.2	HHYG-10015CCB

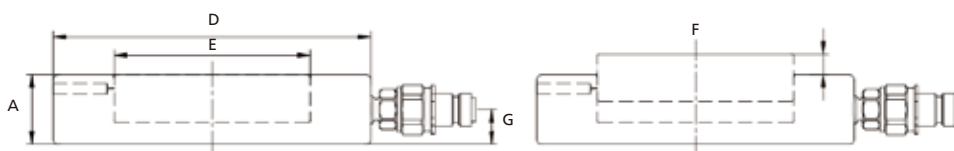

Closed height A (mm)	Extended Height B (mm)	Outside Dia. DXL (mm)	Inside Dia. E (mm)	Piston Rod Dia. F (mm)	Bottom to Advance Port G (mm)	G.W. (Kg)	Recommended pump	Model
30	40	60	21	21	15	0.74	HHB-180	HHYG-510CGB
30	40	70	30	30	15	1.1		HHYG-1010CGB
30	40	90	47	47	15	1.5		HHYG-2510CGB
30	40	118	70	70	15	2.6		HHYG-5010CGB
30	40	152	94	94	16.5	4.3		HHYG-10010CGB
30	40	180	116	116	17	6.8		HHYG-15010CGB
30	40	204	132	132	17	9		HHYG-20010CGB