

OPERATION INSTRUCTION

When you want use this jack,turn the control knob of the valve clovckwise,pull and push the handle,for easy to use you can put it in any position from horizontal to vertical, but the tube must face downwards,if necessary,the components can be combined with the body. When you want release the jack. turn the control knob of the valve counterclockwise.

MAINTENANCE

FOR LOAD:1.Maximun load can not exceed the rated capacity.

3.The load can not exceed the half of the capacity when all tubes used.

4.The extension of the piston can net exceed the stroke.

FOR SAFETY:1.Working oil:Nq 10.

2.Check the level of oil,if it is not sufficient,please add the same hydraulic oil.

3.After using, colse the valve with the cover,to keep the oil free from the dust and dirt.

4.Before lifting,adjust the jack siowly to make the load coaxial with resnect to the jack.

5.Tube can not be bent, near to the catting tools and fires,also can not put te weight on it.

SPECIFICATIONS

Capacity	20ton
Max lifting height	145mm
Cylindrt min height	330mm
Working pressure	480mm
Oil be filled	750g
Net weight	41kg

HYDRAULIC RAM

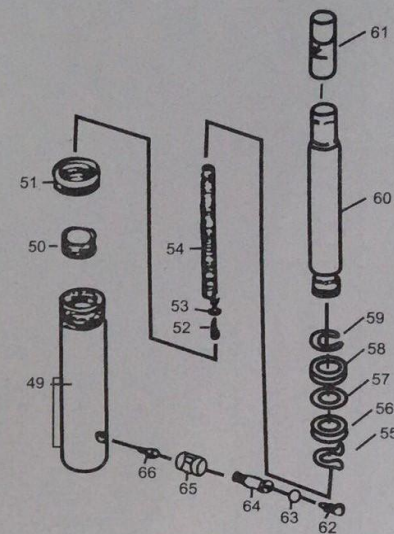

PARTS LIST

Part No.	Description	QTY	Part No.	Description	QTY
41	Retaining ring	2	61	Cover	1
42	Pin	1	62	Dust Proof Cover	2
43	Handle Scket	1	63	O-Ring	2
44	Handle	1	64	Cylinder Screw	2
45	Handle Sleeve	1	65	Connection Nut	2
46	Screw	1	66	Screw	1
47	Spring	1	67	Fixed jaw	1
48	Bushing	1	68	Small Piston	1
49	Cylinder	1	69	Piston Ring	1
50	Ring For Ran	1	70	O-Ring	1
51	Screw Cover	1	71	Screw Cover	1
52	Screw	1	72	Movable Jaw	1
53	Nut	1	73	Pin	1
54	Pull Spring	1	74	Ret	2
55	Retaining Ring	1	75	aining Ring	1
56	O-Ring	1		Sping	
57	Nylon Sealing Ring	1			
58	Bushing	1			
59	Retaning Ring	1			
60	Piston Rod	1			

POWER-KIT

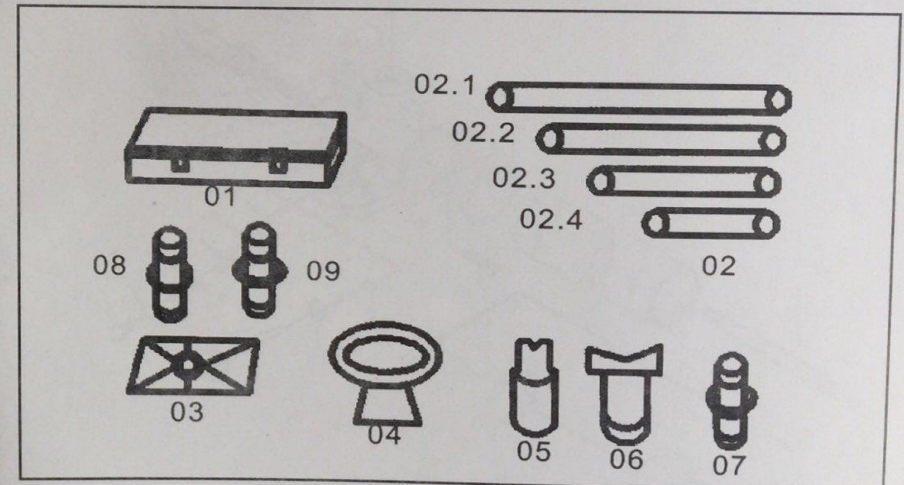
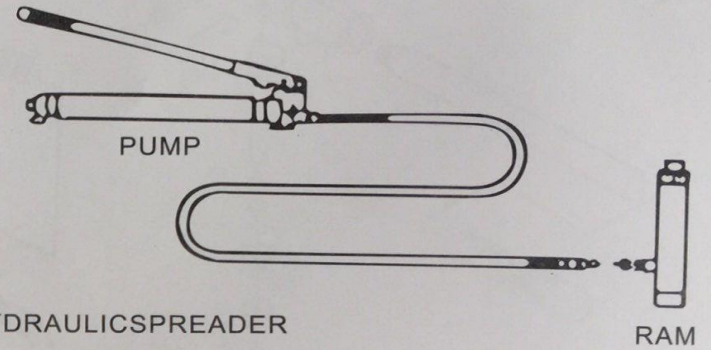

BODY/FRAME REPAIR EQUIPMENT POWER-KIT

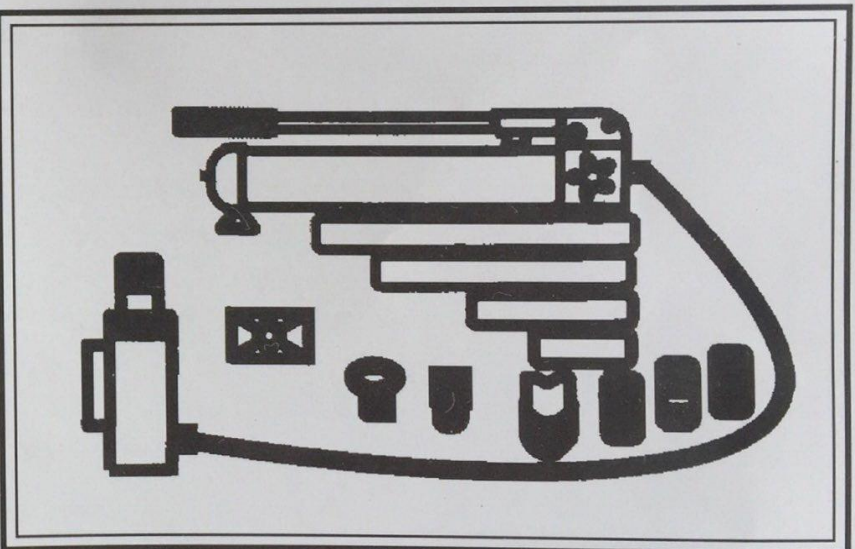

TROUBLESHOOTING CHART

Stop using this equipment immediately if any of the following problems occur, as it may cause personal injury. Any repairs or replacement must be done by a qualified person or an authorized service center only.

PROBLEM	POSSIBLE CAUSE(S)	SOLUTION
When use this equipment, after correctly connection as per operation manual, pump up the handle, the ram doesn't work	1. the steel ball is immersed inside for too long time.	1. Please follow the steps: 1)release the valve, pump up the handle for 10-15 times. 2)Close the valve, pump up the handle for another 5-10 times. 3)Repeat step 1) and 2) for about 3 three times, this problem will be settled.
		1. Tighten the knob of the valve.
When use this equipment, after correctly connection as per operation manual, pump up the handle, the ram at first goes up and then descends.	1. unlock of the valve. 2. Scrap iron inside the valve cause unable to be shut off.	1. Tighten the knob of the valve.
		2. Please follow the steps: 1)Release the pressure by turning the knob anti-clockwise pump up the handle 10-15 times. 2)Close the valve. Pump up the handle 5-10 times. 3)Repeat the step 1) and 2), the problem will be settled.
When use this equipment, after correctly connection as per operation manual, the ram is found gradient and the piston rod curved.	1. Uncorrect of connection or unbalance of the footing	1. Stop work immediately, be sure of correct connection of the ram and the base, and put it on the hard ground. Always be secure of its vertical position

Maintenance:

After used for 30-50 times, ideal to change the hydraulic oil on the condition of the equipment not on working. Turn on the screw on the rear of the pump, empty the used hydraulic oil, then injection with fresh oil by oil gun. The recommendatory oil volume is stated below. Do not add oil excessive or the piston rod can not be repositied normally. If so, turn on the screw on the rear of the pump to discharge unwanted air, then tighten it after the piston rod is repositied

Availabu Capacity of hydraulic oil of 4Ton pump 250g±5g
Availabu Capacity of hydraulic oil of 10Ton pump 500g±5g