



# LIFTING TOOLS HYDRAULIC CYLINDERS



## General Purpose Telescopic Cylinders

Working pressure : 700bar



### Characteristics:

- For use where there is a minimum clearance for the insertion of cylinder and a very high lift is necessary.
- Single acting, load return.
- High strength alloy steel for durability.
- Chrome plated piston resists wear and corrosion.
- Baked enamel finish for increased corrosion resistance.
- Each cylinder has an HH-II R2 3/8 male half coupler and dust cap.
- Each cylinder has a flat grooved saddle.



Combination of long piston stroke and small retracted height.

Model	Cylinder Capacity @700 bar			Stroke (mm)	Total stroke (mm)
	Ton	stage number	KN		
HHYG-10270D	10	2	111	135	270
		1	309	135	
HHYG-10435D	10	3	111	145	435
		2	309	145	
		1	665	145	
HHYG-15300D	15	2	166	150	300
		1	445	150	
		3	166	170	
HHYG-15510D	15	2	445	170	510
		1	1002	170	
		2	309	150	
HHYG-30300D	30	1	665	150	300
		3	309	200	
		2	665	200	
HHYG-30600D	30	1	1496	200	600
		2	496	150	
		1	1002	150	
HHYG-50300D	50	2	496	200	300
		1	1002	200	
		3	496	200	
HHYG-50600D	50	2	1002	200	600
		1	1984	200	
		3	496	200	



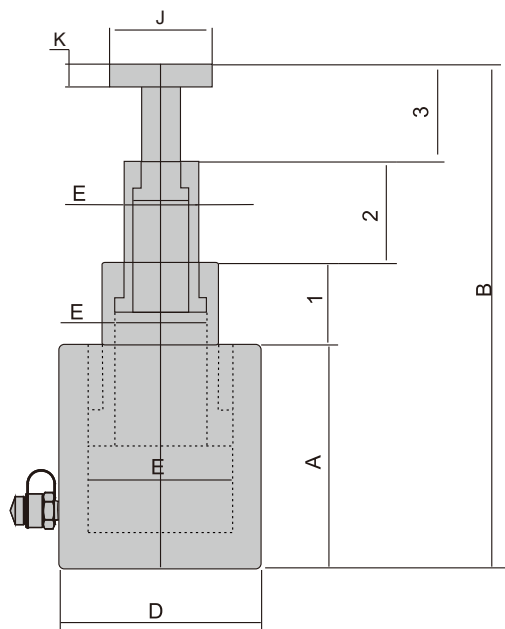
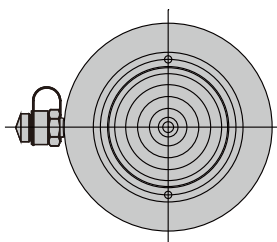

Effective area (cm <sup>2</sup> )	Oil capacity (cm <sup>3</sup> )	Closed height A (mm)	Outside Dia. D (mm)	Inside Dia. E (mm)	G.W. (Kg)	Standard Saddle Dia. J (mm)	Saddle Protr. From Plgr. K (mm)	Handle	Recommended pump	Model
15.9 44.2	810	250	110	45 75	18	48	19	Eye bolts	HHB-700A	HHYG-10270D
15.9 44.2	2250	280	153	45 75	40	78	19	Eye bolts		HHYG-10435D
95.0 23.7 63.6	1308	280	125	55 90	28	63	19	Eye bolts		HHYG-15300D
23.7 63.6 143.1	3543	320	175	55 90 135	60	112	19	Eye bolts	HHB-630A	HHYG-15510D
44.2 95.0	2088	304	152	75 110	45	85	23	Eye bolts	HHB-700A	HHYG-30300D
44.2 95.0 213.7	6803	366	220	75 110 165	106	142	23	Eye bolts	HHB-630A	HHYG-30600D
70.8 143.1	3800	350	170	95 135	68	105	29	Eye bolts		HHYG-50300D
70.8 143.1 283.4	9500	390	230	95 135 190	152	160	29	Eye bolts		HHYG-50600D